

# FAIRMONT SCOTTSDALE PRINCESS

## *Presidential Suite (Main Building)*

### **LIVING/PARLOR AREA:**

- Approximately 2,100 square feet
- Located on the fourth floor of the Main Building
- Views of the South Pool, golf course and lagoons
- Double door foyer entrance
- Oval dark wood dining table that seats up to six
- Additional sofa, coffee table and lounge chairs
- Armoire w/50" LG flat screen TV and DVD player
- Stone fireplace with candles
- Work desk with speakerphone
- Wireless high-speed Internet access, express check out
- Large built-in bar with two sinks and four bar stools
- Full size refrigerator and microwave
- Luxurious, contemporary-style furnishings

### **PARLOR BATHROOM:**

- Oversize bathtub, shower w/glass door
- Granite countertops and sink

### **BEDROOM AREA:**

- Approximately 600 square feet
- Dark wood four-poster bed
- L-shaped sofa, coffee table and chairs
- Armoire w/42" LG flat screen TV
- iHome clock radio and work desk w/speakerphone
- Separate dressing room and full-length mirror
- Option for one or two bedrooms connecting

### **BATHROOM:**

- Granite countertops and dual sinks
- 12- inch flat screen TV in mirror
- Oversized granite Jacuzzi tub and shower
- Separate water closet
- Walk-in closet with bureau
- Room safe
- Iron and full size ironing board
- Two plush bathrobes
- Bathroom scale and hair dryer

### **PATIO:**

Covered patios with tables, chairs and lounges

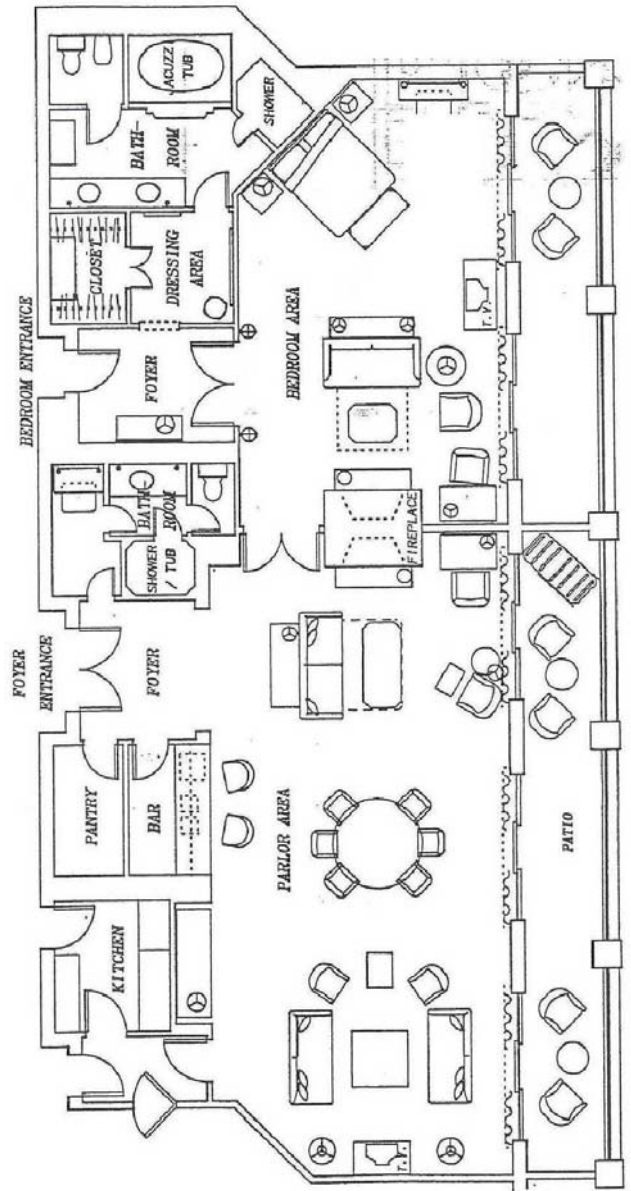

*One Bedroom Suite: 2,700 square ft  
Two Bedroom Suite: 3,225 square ft  
Parlor Only: 2,100 square ft*